

样品承认书

SAMPLE ACKNOWLEDGMENT

文件编号: GS-QMS40101

版本版次: 2006/01

附文件: 共 2 页

客户名称 Customer: _____
 客户料号 Materiel No: _____
 产品型号 Model: R05RGBC-A001
 编 号 NO: GS09011402
 日 期 Date: 2009/01/15

| 客户栏 Customer | | | |
|--------------|------------|-------------|----------|
| 发行章 Cachet | 核准 Approve | 审核 Auditing | 承认 Admit |
| | | | |

| 厂商栏 Manufacturer | | | |
|------------------|------------|-------------|----------|
| 发行章 Cachet | 核准 Approve | 审核 Auditing | 制表 Admit |
| | | | 杨伟 |

尊敬的客户: 请收到我公司样品承认书三日内回传承认书首页, 谢谢!

1. SPECIFICATIONS

(1) Absolute Maximum Rating/极限参数 (Ta=25°C)

| Parameter 参数 | Symbol 符号 | Absolute Maximun Rating 极限参数 | Unit 单位 |
|---------------------------------|-----------|------------------------------|---------|
| Max Forward curren/正向最大电流 | If | 30 | mA |
| Work Forward Cuttent/工作电流 | IF | 20 | mA |
| Reverse Voltage/反向电压 | Vr | 5 | V |
| Power Dissipstion/损耗功率 | Pd | 120 | mw |
| Electrostatic Discharge/抗静电电压 | ESD | 800 | V |
| Operating Temperature/工作温度范围 | Top | -40°C~80°C | °C |
| Storage Temperature/储存温度范围 | Tstg | -40°C~100°C | °C |
| Lead Soldering Temperature/焊接温度 | Tsol | 260°C For 5 Seconds Max | |

IFP Conditions: Pulse Width ≤ 10msec and duty ≤ 1/10

(2) Initial Electrical/Opitcal Characteristics/光电参数 (Ta=25°C)

| Parameter 参数 | Symbol 符号 | Condition 测试条件 | Min | Typ | Max | Unit 单位 | | | |
|---------------------------|-----------|----------------|-----|------|-----|---------|---|------|-----|
| Forward Voltage / 正向电压 | VF | IF = 20mA | R | 1.8 | R | -- | R | 2.2 | V |
| | | | G | 3.0 | G | -- | G | 3.4 | |
| | | | B | 3.0 | B | -- | B | 3.4 | |
| Reverse Current / 反向电流 | IR | VR = 5V | | | 10 | μA | | | |
| Luminous Intensity / 发光强度 | IV | IF = 20mA | R | 2000 | R | -- | R | 4000 | mcd |
| | | | G | 4000 | G | -- | G | 6000 | |
| | | | B | 4000 | B | -- | B | 6000 | |
| Peak Wavelength / 主波长 | λD | IF = 20mA | R | 620 | R | -- | R | 630 | nm |
| | | | G | 520 | G | -- | G | 530 | |
| | | | B | 465 | B | -- | B | 470 | |

2. Package Dimensions

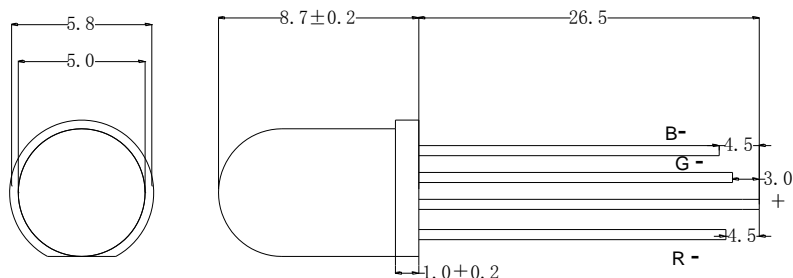

| Part Number | Chip | | Lens Color |
|--------------|---------------|----------------|-------------|
| | Material | Emitting Color | |
| R05RGBC-A001 | InGaN-AlInGaP | R/G/B | Water Clear |

NOTES:

- All dimension are millimeters
- Tolerance is ± 0.25mm unless otherwise noted