

**P.C.B LAYOUT
TOP VIEW**

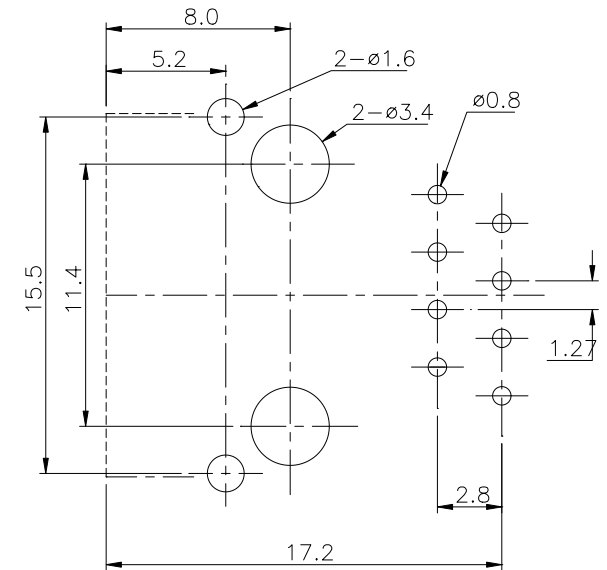

SPECIFICATION

1. Rating: AC 125V 1.5A;
2. Contact resistance: $\leq 30m\Omega$ □
- Roman|b0|i0|c0|p18;;
3. Insulation resistance: $\geq 100M\Omega$; (DC500V);
4. Withstand voltage: 1000VAC;
5. Insertion force: 15N,
Extraction force: 15N,
Locking force: 75N;
6. Life test: 750 Mating cycles min.

3	EARTH FOOT	1	BRASS	Ni-Plating		
2	CONTACT FOOT	8	BRONZE	Au-Plating		
1	HOUSING	1	PBT/ABS			
NO.	DESCRIPTION	QTY	MATERIAL	PLATING		
UNIT:MM	TYPE:	MODEL NO:		PAPER NO: A4		
	PCB JACK	PCB-829 (8P8C)	PAGE 1 OF 1			
			TOLERANCE	ANGLES	SCALE	VER
			0.15	数1.5	3:1	1
DESIGNER BY:						
CHECK BY:						
APPROVED BY:						



旭日佳电子有限公司 □
BEST SUN ELECTRONIC CO., LTD