



International
Network —
Connectors



CONNECTOR GUIDE

MIL-DTL 5015 Series Connectors

MIL-DTL 26482 Series 1 Connectors

VG95234 Series Connectors

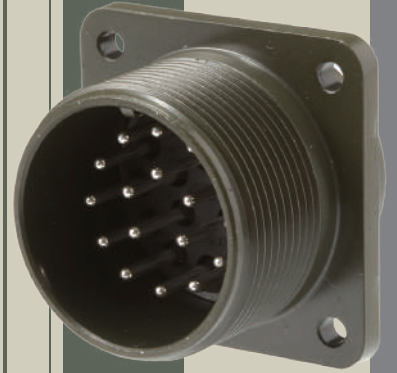

MIL-DTL 5015 Series

CONNECTORS



Table of Contents	page
Ordering Information	4
Typical Mating Guide	4
Technical Specifications	5
Contact and Insert Arrangements	
Insert Arrangement & Alternate Positioning	6
Contact Arrangement	8
MIL-DTL 5015 Series	
Wall Mounting Receptacle (I/MS 3100)	16
Cable Connecting Plug (I/MS 3101)	17
Box Mounting Receptacle (I/MS 3102)	19
Straight Plug (I/MS 3106)	19
Right Angle Plug (I/MS 3108)	21
MIL-DTL 5015 Accessories	
Cable clamp (I/MS 3057)	22
Telescoping Bushing (I/MS 3420)	22
Protective Cover for Receptacle (I/MS 25043)	23
Protective Cover for Plug (I/MS 25042)	23

This Connector Guide is intended to provide general information about various products. Information contained herein is for general reference only and subject to change without notice. Products may deviate from the listed description, specifications, technical data, dimensions and illustrations provided in this Connector Guide. Please contact INC to discuss your specific application to ensure that the desired products meet your specific requirements. No information or data contained in this Connector Guide shall be construed to create any liability on the part of INC.

Ordering Information

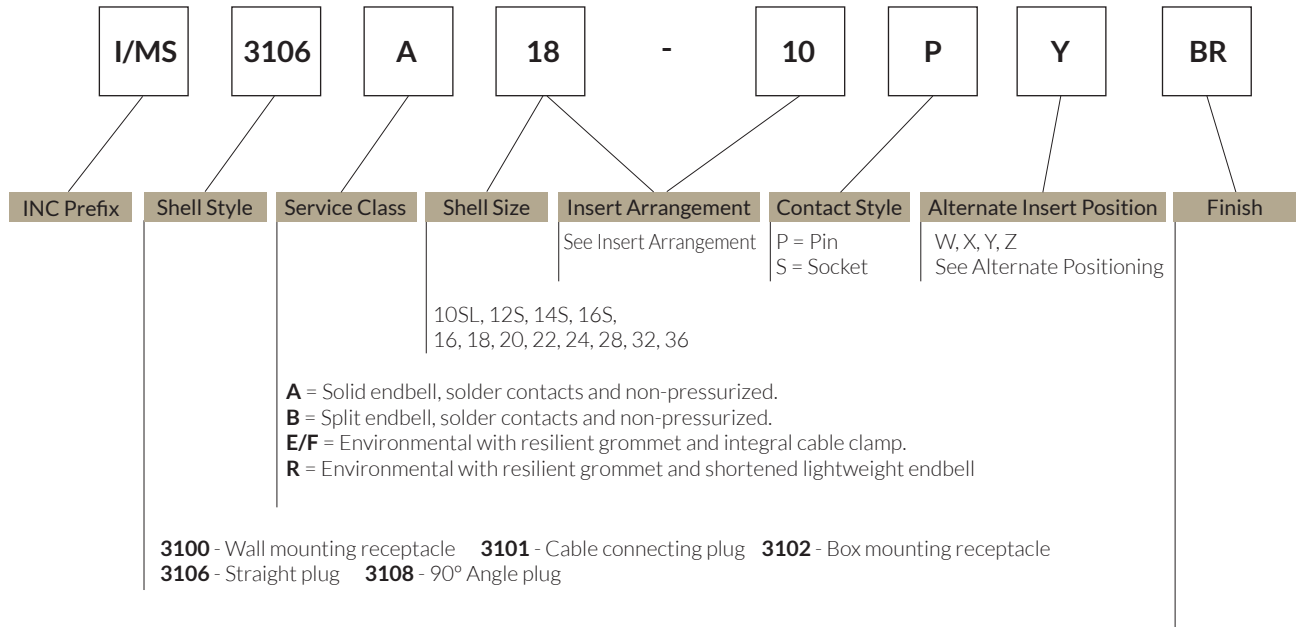

- Blank** - Olive Drab over Zinc (default)
- BLK** - Black Zinc
- BR** - Electro-deposited Black (RoHS), 500hrs salt spray test
- BZR** - Black Zinc RoHS (Black trivalent chromate over zinc plating)
- EN** - Electroless Nickel (RoHS)
- N** - Nickel (RoHS)
- OR** - Electro-deposited Olive Drab (RoHS), 500hrs salt spray test

Customization / Modification requirements : Please contact INC.

Typical Mating Guide

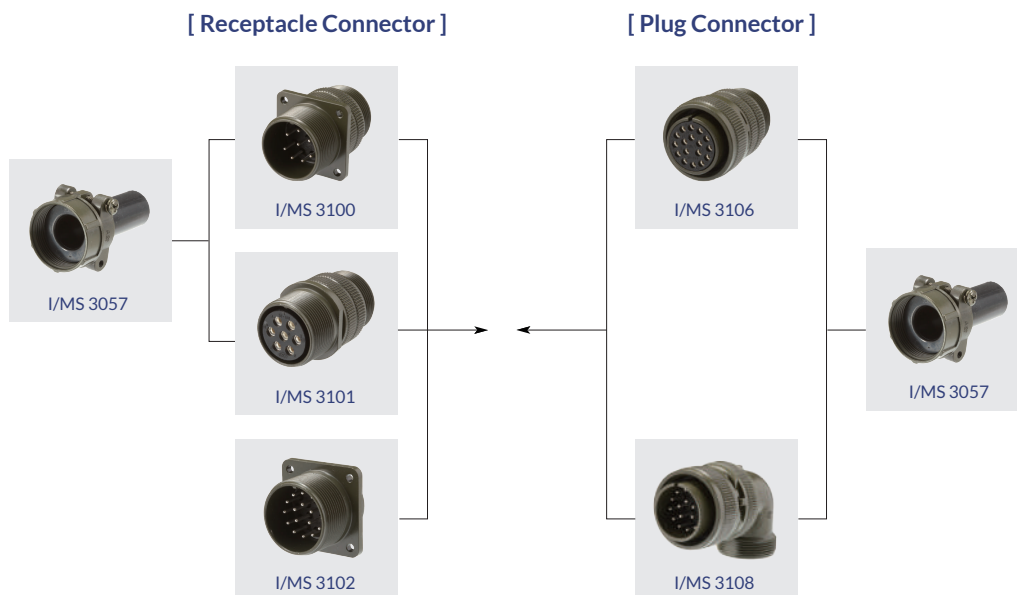

Technical Specifications

[Materials & Finishes]

Shell, Endbell	Aluminum alloy / Olive drab chromate coating over zinc plating (Refer to Ordering Information page for alternative finish options)
Insulator	Synthetic rubber
Contact	Copper alloy / Silver plating
Gasket and Grommet	Synthetic rubber

[Electrical Data]

Operating Voltage Test Voltage	Service Rating	Operating Voltage	Operating Voltage	Test Voltage	Air Spacing	Creepage
		DC V	AC V r.m.s	AC V r.m.s	Nominal (Inches)	Nominal (Inches)
	Inst.	250	200	1000	-	1/16
	A	700	500	2000	1/16	1/8
	D	1250	900	2800	1/8	3/16
	E	1750	1250	3500	3/16	1/4
	B	2450	1750	4500	1/4	5/16
	C	4200	3000	7000	5/16	1

Current Rating at 68°F (+20°C)	Contact Size	Contact Resistance	Test Current	Potential Drop
		Milliohm Max.	(Amps)	(Millivolts)
	16	16	13	49
	12	3	23	42
	8	1	46	26
	4	0.5	80	23
	0	0.2	150	21

Insulator Resistance Min. 5000 MΩ at 77°F (+25°C) per MIL-DTL-5015, 3.18

[Mechanical Data]

Operating Temperature -67°F (-55°C) to +257°F (+125°C)

Contact Size	Insulation Outside Diameter Limit			
	Min. (Inches)	Min. (mm)	Max. (Inches)	Max. (mm)
16	0.064	1.63	0.130	3.30
12	0.114	2.90	0.170	4.32
8	0.164	4.17	0.255	6.48
4	0.275	6.98	0.371	9.40
0	0.145	10.54	0.550	13.97

Durability 100 cycles of mating / unmating operations to MIL-DTL-5015, 3.16
Salt Spray Unmated connectors and contacts meet 48-hour exposure per EIA364.26 test condition letter B and MIL-DTL-5015 3.17
Chemical Resistance 20 hours full immersion unmated in hydraulic fluid and lubricating oil per MIL-DTL-5015
Vibration 10 to 2000Hz (10G units) 10 microseconds maximum discontinuity to MIL-STD-1344 Method 2005, condition II per MIL-DTL-5015
Shock 50G units 11 millisecond duration, three major axes. 10 microseconds maximum discontinuity to MIL-DTL-5015 per MIL-STD-1344 Method 2004, condition A

Contact Retention & Separation Forces	Contact Size	Axial Load		Separation Force Min.	
		Newtons	Lbs.	Newtons	Lbs.
	16	44	10	1	0.25
	12	67	15	2	0.50
	8	89	20	3	0.75
	4	89	20	4	1.00
	0	111	25	9	2.00

Insert Arrangement & Alternate Positioning

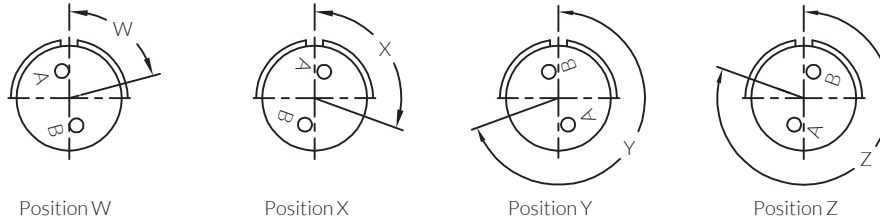

View shows front face of pin insert or rear of socket insert

Insert Arrangement	Service Rating	Total Contacts	Contact Size					Alternate Position Degrees			
			0	4	8	12	16	W	X	Y	Z
10SL-3	A	3					3	-	-	-	-
10SL-4	A	2					2	-	-	-	-
12S-3	A	2					2	70	145	215	290
12S-4	D	1					1	-	-	-	-
12-5	D	1				1		-	-	-	-
14S-1	A	3					3	-	-	-	-
14S-2	Inst.	4					4	-	120	240	-
14S-4	D	1					1	-	-	-	-
14S-5	Inst.	5					5	-	110	-	-
14S-6	Inst.	6					6	-	-	-	-
14S-7	A	3					3	90	180	270	-
14S-9	A	2					2	70	145	215	290
16S-1	A	7					7	80	-	-	280
16S-3	B	1					1	-	-	-	-
16S-4	D	2					2	35	110	250	325
16S-5	A	3					3	70	145	215	290
16S-6	A	3					3	90	180	270	-
16S-8	A	5					5	-	170	265	-
16-2	E	1				1		-	-	-	-
16-7	A	3			1		2	80	110	250	280
16-9	A	4				2	2	35	110	250	325
16-10	A	3				3		90	180	270	-
16-11	A	2				2		35	110	250	325
16-12	A	1		1				-	-	-	-
16-13	A	2				2		35	110	250	325
18-1	A/Inst.	10					10	70	145	215	290
18-3	D	2				2		35	110	250	325
18-4	D	4				4		35	110	250	325
18-5	D	3				2	1	80	110	250	280
18-6	D	1		1				-	-	-	-
18-7	B	1			1			-	-	-	-
18-8	A	8				1	7	70	-	-	290
18-9	Inst.	7				2	5	80	110	250	280
18-10	A	4				4		-	120	240	-
18-11	A	5				5		-	170	265	-
18-12	A	6				6		80	-	-	280
18-13	A	4			1	3		80	110	250	280
18-14	A	2		1		1		80	110	250	280
18-15	A	4				4		-	120	240	-
18-16	C	1				1		-	-	-	-

Insert Arrangement	Service Rating	Total Contacts	Contact Size					Alternate Position Degrees			
			0	4	8	12	16	W	X	Y	Z
18-19	A	10					10	-	120	240	-
18-20	A	5				5		90	180	270	-
18-21	A	3				3		-	-	-	-
18-22	D	3				3		70	145	215	290
18-29	A	5				5		90	180	270	-
18-32	A	8					8	-	-	-	-
20-01	A	10					10	-	-	-	-
20-3	D	3				3		70	145	215	290
20-4	D	4				4		45	110	250	-
20-6	D	3					3	70	145	215	290
20-7	D/A	8					8	80	110	250	280
20-8	Inst.	6			2		4	80	110	250	280
20-9	D/A	8				1	7	80	110	250	280
20-11	Inst.	13					13	-	-	-	-
20-12	A	2		1			1	80	110	250	280
20-14	A	5			2	3		80	110	250	280
20-15	A	7				7		80	-	-	280
20-16	A	9				2	7	80	110	250	280
20-17	A	6				5	1	90	180	270	-
20-18	A	9				3	6	35	110	250	325
20-19	A	3				3		90	180	270	-
20-20	A	4		1		3		80	110	250	280
20-21	A	9				1	8	35	110	250	325
20-22	A	6				3	3	80	110	250	280
20-23	A	2				2		35	110	250	325
20-24	A	4				2	2	35	110	250	325
20-27	A	14					14	35	110	250	325
20-29	A	17					17	80	-	-	280
20-33	A	11					11	-	-	-	-
20A48	A	19					19	-	80	280	-
22-1	D	2				2		35	110	250	325
22-2	D	3				3		70	145	215	290
22-4	A	4				2	2	35	110	250	325
22-5	D	6				2	4	35	110	250	325
22-6	D	3				2	1	80	110	250	280
22-7	E	1	1					-	-	-	-
22-8	E	2				2		35	110	250	325
22-9	E	3				3		70	145	215	290
22-10	E	4				4		35	110	250	325
22-12	D	5				2	3	80	110	250	280

Insert Arrangement & Alternate Positioning

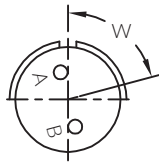

Position W

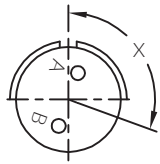

Position X

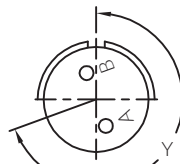

Position Y

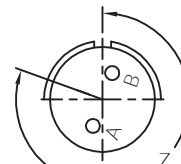

Position Z

View shows front face of pin insert or rear of socket insert

Insert Arrangement	Service Rating	Total Contacts	Contact Size					Alternate Position Degrees			
			0	4	8	12	16	W	X	Y	Z
22-13	D/A	5				4	1	35	110	250	325
22-14	A	19					19	80	110	250	280
22-15	E/A	6				5	1	80	110	250	280
22-16	A	9				3	6	80	110	250	280
22-17	D/A	9				1	8	80	110	250	280
22-18	A/D	8					8	80	110	250	280
22-19	A	14					14	80	110	250	280
22-20	A	9					9	35	110	250	325
22-21	A	3	1				2	80	110	250	280
22-22	A	4			4			-	110	250	-
22-23	D/A	8				8		35	-	250	-
22-24	D/A	6				2	4	80	110	250	280
22-27	D/A	9			1		8	80	-	250	280
22-28	A	7				7		80	-	-	280
22-33	A/D	7					7	80	110	250	280
22-34	D	5				3	2	80	110	250	280
22-36	D/A	8				8		90	-	270	-
24-2	D	7				7		80	-	-	280
24-3	D	7				2	5	80	110	250	280
24-5	A	16					16	80	110	250	280
24-6	D/A	8				8		80	110	250	280
24-7	A	16				2	4	80	110	250	280
24-9	A	2		2				35	110	250	325
24-10	A	7			7			80	-	-	280
24-11	A	9			3	6		35	110	250	325
24-12	A	5		2		3		80	110	250	280
24-16	D/A	7			1	3	3	80	110	250	280
24-17	D	5				2	3	80	110	250	280
24-20	D	11				2	9	80	110	250	280
24-21	D	10			1		9	80	110	250	280
24-22	D	4			4			45	110	250	-
24-27	E	7					7	80	-	-	280
24-28	Inst.	24					24	80	110	250	280
28-1	D/A	9			3	6		80	110	250	280
28-2	D	14				2	12	35	110	250	325
28-3	E	3			3			70	145	215	290
28-4	E/D	9				2	7	80	110	250	280
28-5	D	5		2		1	2	35	110	250	325
28-6	D	3		3				70	145	215	290
28-8	E/D/A	12				2	10	80	110	250	280

Insert Arrangement	Service Rating	Total Contacts	Contact Size					Alternate Position Degrees			
			0	4	8	12	16	W	X	Y	Z
28-9	D	12				6	6	80	110	250	280
28-10	D/A	7		2	2	3		80	110	250	280
28-11	A	22				4	18	80	110	250	280
28-12	A	26					26	90	180	270	-
28-15	A	35					35	80	110	250	280
28-16	A	20					20	80	110	250	280
28-17	B/D/A	15					15	80	110	250	280
28-18	C/A/INST/D	12					12	70	145	215	290
28-19	B/D/A	10				4	6	80	110	250	280
28-20	A	14				10	4	80	110	250	280
28-21	A	37					37	80	110	250	280
28-22	D	6		3			3	70	145	215	290
28-51	D	12				12		80	135	195	-
32-1	E/D	5	2			3		80	110	250	280
32-2	E	5		3			2	70	145	215	290
32-3	D	9	1	2		2	4	80	110	250	280
32-4	D/A	14				2	12	80	110	250	280
32-5	D	2	2					80	110	250	325
32-6	A	23		2	3	2	16	80	110	250	280
32-7	Inst./A	35				7	28	80	125	235	280
32-8	A	30				6	24	80	125	235	280
32-9	D	14		2			12	80	110	250	280
32-10	E/B/D/A	7		2	2		3	80	110	250	280
32-12	A/D	15				5	10	80	110	250	280
32-13	D	23				5	18	80	110	250	280
32-15	D	8	2			6		35	110	250	280
32-17	D	4		4				45	110	250	-
36-1	D	22				4	18	80	110	250	280
36-3	D	6	3			3		70	145	215	290
36-4	D/A	3	3					70	145	215	290
36-5	A	4	4					-	120	240	-
36-6	A	6	2	4				35	110	250	325
36-7	A	47				7	40	80	110	250	280
36-8	A	47				1	46	80	110	250	280
36-9	A	31		1	2	14	14	80	125	235	280
36-10	A	48					48	80	125	235	280
36-13	E/A	17				2	15	80	110	250	280
36-14	D	16			5	5	6	90	180	270	-
36-15	D/A	35					35	60	125	245	270
36-52	A	52					52	72	144	216	288

Contact Arrangement

Front face of pin insert or rear face of socket insert illustrated.

CONTACT LEGEND



1 CONTACT

Insert Arrangement	12S-4	12-5	14S-4	16S-3	16-2
Contact Size - No. of Contacts	#16-1	#12-1	#16-1	#16-1	#12-1
Service Rating	D	D	D	B	E
Insert Arrangement	16-12	18-6	18-7	18-16	22-7
Contact Size - No. of Contacts	#4-1	#4-1	#8-1	#12-1	#0-1
Service Rating	A	D	B	C	E

2 CONTACTS

Insert Arrangement	10SL-4	12S-3	14S-9	16S-4	16-11
Contact Size - No. of Contacts	#16-2	#16-2	#16-2	#16-2	#12-2
Service Rating	A	A	A	D	A
Insert Arrangement	16-13	18-3	18-14	20-12	20-23
Contact Size - No. of Contacts	#12-2	#12-2	#16-1, #4-1	#16-1, #4-1	#8-2
Service Rating	A	D	A	A	A
Insert Arrangement	22-1	22-8	24-9	32-5	
Contact Size - No. of Contacts	#8-2	#12-2	#4-2	#0-2	
Service Rating	D	E	A	D	

Contact Arrangement

Front face of pin insert or rear face of socket insert illustrated.

CONTACT LEGEND



3 CONTACTS



Insert Arrangement	10SL-3	14S-1	14S-7	16S-5	16S-6	16-7
Contact Size - No. of Contacts	#16-3	#16-3	#16-3	#16-3	#16-3	#16-2, #8-1
Service Rating	A	A	A	A	A	A



Insert Arrangement	16-10	18-5	18-21	18-22	20-3
Contact Size - No. of Contacts	#12-3	#16-1, #12-2	#12-3	#16-3	#12-3
Service Rating	A	D	A	D	D

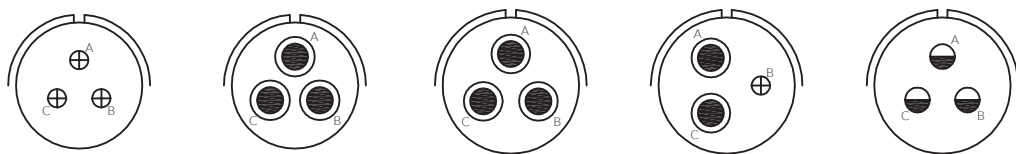

Insert Arrangement	20-6	20-19	22-2	22-6	22-9
Contact Size - No. of Contacts	#16-3	#8-3	#8-3	#16-1, #8-2	#12-3
Service Rating	D	A	D	C	E

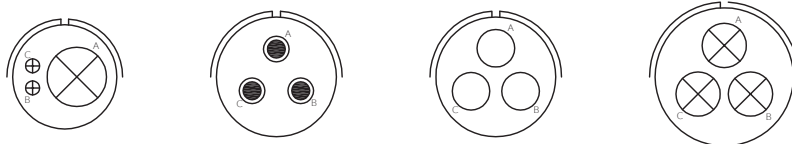

Insert Arrangement	22-21	28-3	28-6	36-4
Contact Size - No. of Contacts	#16-2, #0-1	#8-3	#4-3	#0-3
Service Rating	A	E	D	D(A) / A(B,C)

4 CONTACTS



Insert Arrangement	14S-2	16-9	18-4	18-10	18-13	18-15
Contact Size - No. of Contacts	#16-4	#16-2, #12-2	#16-4	#12-4	#12-3, #8-1	#12-4
Service Rating	Inst.	A	D	A	A	A

Contact Arrangement

Front face of pin insert or rear face of socket insert illustrated.



4 CONTACTS

Insert Arrangement	20-4	20-20	20-24	22-4	22-10
Contact Size - No. of Contacts	#12-4	#12-3, #4-1	#16-2, #8-2	#12-2, #8-2	#16-4
Service Rating	D	A	A	A	E
Insert Arrangement	22-22	24-22	32-17	36-5	
Contact Size - No. of Contacts	#8-4	#8-4	#4-4	#0-4	
Service Rating	A	D	D	A	

5 CONTACTS

Insert Arrangement	14S-5	16S-8	18-11	18-20	18-29
Contact Size - No. of Contacts	#16-5	#16-5	#12-5	#16-5	#16-5
Service Rating	Inst.	A	A	A	A
Insert Arrangement	20-14	22-12	22-13	22-34	24-12
Contact Size - No. of Contacts	#12-3, #8-2	#16-3, #8-2	#16-1, #12-4	#16-2, #12-3	#12-3, #4-2
Service Rating	A	D	D(E) / A(All others)	D	A
Insert Arrangement	24-17	28-5	32-1	32-2	
Contact Size - No. of Contacts	#16-3, #12-2	#16-2, #12-1, #4-2	#12-3, #0-2	#16-2, #4-3	
Service Rating	D	D	E(A) / D(All others)	E	

Contact Arrangement

Front face of pin insert or rear face of socket insert illustrated.

CONTACT LEGEND



6 CONTACTS

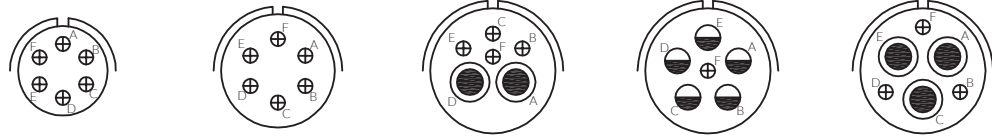

Insert Arrangement	14S-6	18-12	20-8	20-17	20-22
Contact Size - No. of Contacts	#16-6	#16-6	#16-4, #8-2	#16-1, #12-5	#16-3, #8-3
Service Rating	Inst.	A	Inst.	A	A



Insert Arrangement	22-5	22-15	22-24	28-22
Contact Size - No. of Contacts	#16-4, #12-2	#16-1, #12-5	#16-4, #12-2	#16-3, #4-3
Service Rating	D	E(D) / A(All others)	D(C, D, E) / A(All others)	D

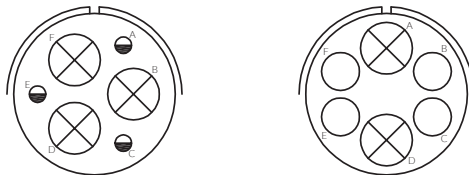

Insert Arrangement	36-3	36-6
Contact Size - No. of Contacts	#12-3, #0-3	#4-4, #0-2
Service Rating	D	A

7 CONTACTS

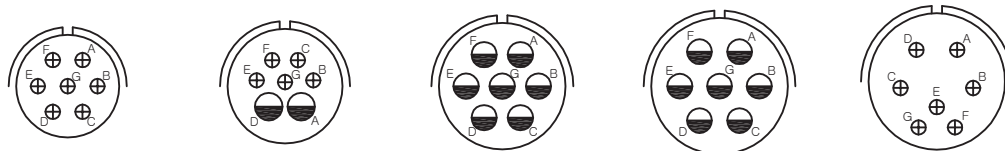

Insert Arrangement	16S-1	18-9	20-15	22-28	22-33
Contact Size - No. of Contacts	#16-7	#16-5, #12-2	#12-7	#12-7	#16-7
Service Rating	A	Inst.	A	A	A(E, F, G) / D(All others)

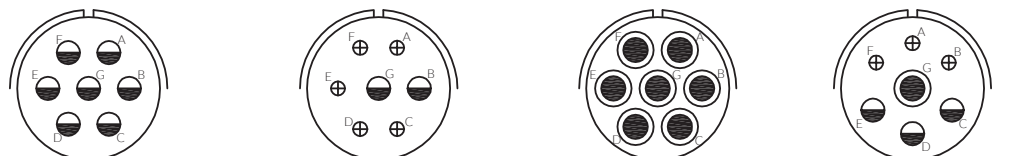

Insert Arrangement	24-2	24-3	24-10	24-16
Contact Size - No. of Contacts	#12-7	#16-5, #12-2	#8-7	#16-3, #12-3, #8-1
Service Rating	D	D	A	D(A, B, F, G) / A(All others)

Contact Arrangement

Front face of pin insert or rear face of socket insert illustrated.



7 CONTACTS



Insert Arrangement	24-27	28-10	32-10
Contact Size - No. of Contacts	#16-7	#12-3, #8-2, #4-2	#16-3, #8-2, #4-2
Service Rating	E	D(G) / A(All others)	E(A, F) / B(G) / D(B, E) / A(C, D)

8 CONTACTS

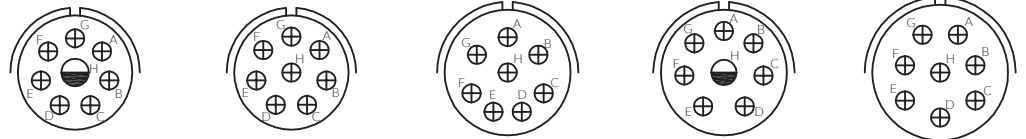

Insert Arrangement	18-8	18-32	20-7	20-9	22-18
Contact Size - No. of Contacts	#16-7, #12-1	#16-8	#16-8	#16-7, #12-1	#16-8
Service Rating	A	A	D(A,B,H,G) / A(All others)	D(H) / A(All others)	A(C,D,E) / D(All others)



Insert Arrangement	22-23	22-36	24-6	32-15
Contact Size - No. of Contacts	#12-8	#12-8	#12-8	#12-6, #0-2
Service Rating	D(H) / A(All others)	D(H) / A(All others)	D(A, G, H) / A(All others)	D

9 CONTACTS

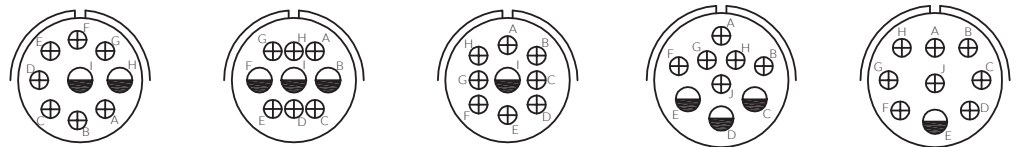

Insert Arrangement	20-16	20-18	20-21	22-16	22-17
Contact Size - No. of Contacts	#16-7, #12-2	#16-6, #12-3	#16-8, #12-1	#16-6, #12-3	#16-8, #12-1
Service Rating	A	A	A	A	D(A) / A(All others)

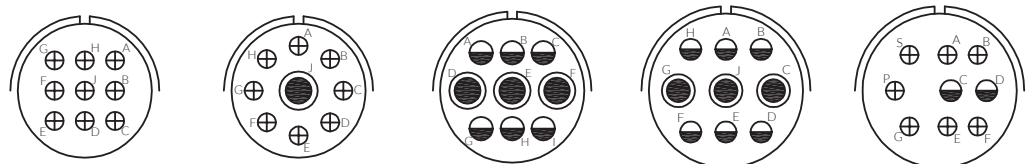

Insert Arrangement	22-20	22-27	24-11	28-1	28-4
Contact Size - No. of Contacts	#16-9	#16-8, #8-1	#12-6, #8-3	#12-6, #8-3	#16-7, #12-2
Service Rating	A	D(J) / A(All others)	A	D(A, J, E) / A(All others)	E(G,P,S) / A(All others)

Contact Arrangement

Front face of pin insert or rear face of socket insert illustrated.



9 CONTACTS

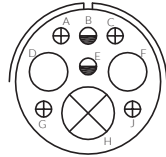

Insert Arrangement	32-3
Contact Size - No. of Contacts	#16-4, #12-2, #4-2, #0-1
Service Rating	D

10 CONTACTS

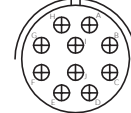
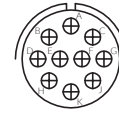
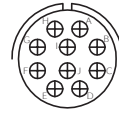

Insert Arrangement	18-1	18-19	20-01
Contact Size - No. of Contacts	#16-10	#16-10	#16-10
Service Rating	A(B, C, F, G) / Inst.(All others)	A	A

10 CONTACTS

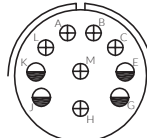
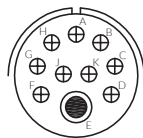

Insert Arrangement	24-21	28-19
Contact Size - No. of Contacts	#16-9, #8-1	#16-6, #12-4
Service Rating	D	B(H, M) / D(A, B) / A(All others)

11 CONTACTS

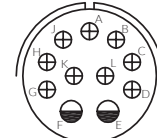
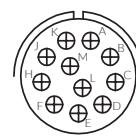

Insert Arrangement	20-33	24-20
Contact Size - No. of Contacts	#16-11	#16-9, #12-2
Service Rating	A	D

12 CONTACTS

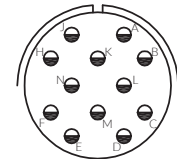
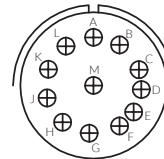
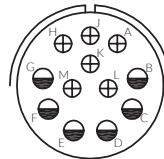
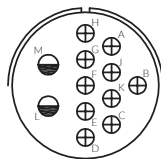

Insert Arrangement	28-8	28-9	28-18	28-51
Contact Size - No. of Contacts	#16-10, #12-2	#16-6, #12-6	#16-12	#12-12
Service Rating	E(L, M) / D(B) / A(All others)	D	C(M) / A(A, B) Inst.(C, D, E, F) D(All others)	D

13 CONTACTS

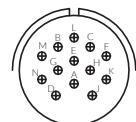

Insert Arrangement	20-11
Contact Size - No. of Contacts	#16-13
Service Rating	Inst.

14 CONTACTS

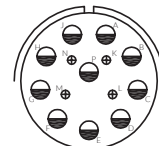
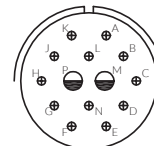
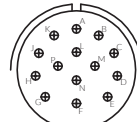
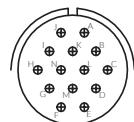

Insert Arrangement	20-27	22-19	28-2	28-20
Contact Size - No. of Contacts	#16-14	#16-14	#16-12, #12-2	#16-4, #12-10
Service Rating	A	A	D	A

Contact Arrangement

Front face of pin insert or rear face of socket insert illustrated.

CONTACT LEGEND



14 CONTACTS

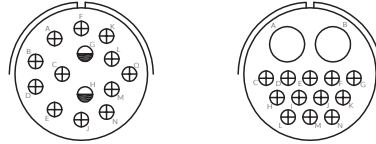

Insert Arrangement	32-4	32-9
Contact Size - No. of Contacts	#16-12, #12-2	#16-12, #4-2
Service Rating	A(F, J, K, N) / D(All others)	D

15 CONTACTS

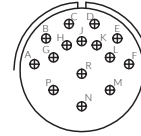

Insert Arrangement	28-17
Contact Size - No. of Contacts	#16-15
Service Rating	B(R) / D(M, N, P) / A(All others)

15 CONTACTS

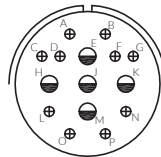

Insert Arrangement	32-12
Contact Size - No. of Contacts	#16-10, #12-5
Service Rating	A(C, D, E, F, G) / D(All others)

16 CONTACTS

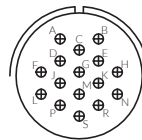

Insert Arrangement	24-5
Contact Size - No. of Contacts	#16-16
Service Rating	A

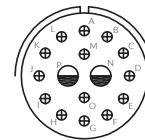

Insert Arrangement	24-7
Contact Size - No. of Contacts	#16-14, #12-2
Service Rating	A

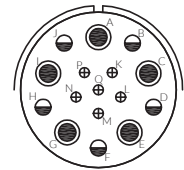

Insert Arrangement	36-14
Contact Size - No. of Contacts	#16-6, #12-5, #8-5
Service Rating	D

17 CONTACTS

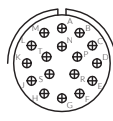

Insert Arrangement	20-29
Contact Size - No. of Contacts	#16-17
Service Rating	A

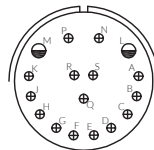

Insert Arrangement	36-13
Contact Size - No. of Contacts	#16-15, #12-2
Service Rating	A

19 CONTACTS

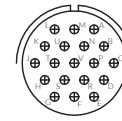

Insert Arrangement	22-14
Contact Size - No. of Contacts	#16-19
Service Rating	A

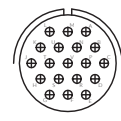

Insert Arrangement	20A48
Contact Size - No. of Contacts	#16-19
Service Rating	A

20 CONTACTS

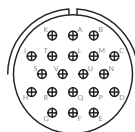

Insert Arrangement	28-16
Contact Size - No. of Contacts	#16-20
Service Rating	A

22 CONTACTS

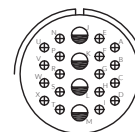

Insert Arrangement	28-11
Contact Size - No. of Contacts	#16-18, #12-4
Service Rating	A

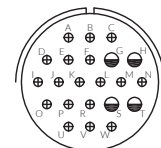

Insert Arrangement	36-1
Contact Size - No. of Contacts	#16-18, #12-4
Service Rating	D

Contact Arrangement

Front face of pin insert or rear face of socket insert illustrated.

CONTACT LEGEND



23 CONTACTS

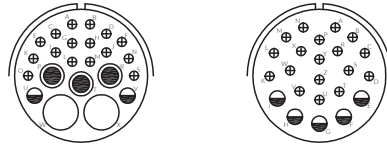

Insert Arrangement	32-6	32-13
Contact Size - No. of Contacts	#16-16, #12-2, #8-3, #4-2	#16-18, #12-5
Service Rating	A	D

24 CONTACTS

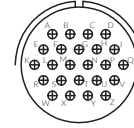

Insert Arrangement	24-28
Contact Size - No. of Contacts	#16-24
Service Rating	Inst.

26 CONTACTS

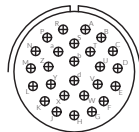

Insert Arrangement	28-12
Contact Size - No. of Contacts	#16-26
Service Rating	A

30 CONTACTS

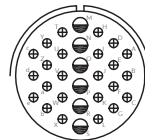

Insert Arrangement	32-8
Contact Size - No. of Contacts	#16-24, #12-6
Service Rating	A

31 CONTACTS

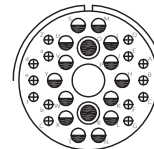

Insert Arrangement	36-9
Contact Size - No. of Contacts	#16-14, #12-14, #8-2, #4-1
Service Rating	A

35 CONTACTS

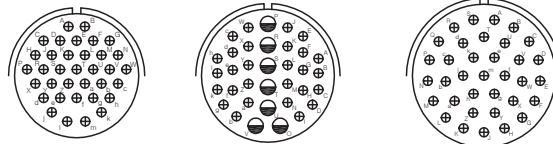

Insert Arrangement	28-15	32-7	36-15
Contact Size - No. of Contacts	#16-35	#16-28, #12-7	#16-35
Service Rating	A	Inst.(A, B, h, j) / A(All others)	D(M) / A(All others)

37 CONTACTS

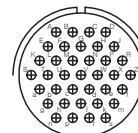

Insert Arrangement	28-21
Contact Size - No. of Contacts	#16-37
Service Rating	A

47 CONTACTS

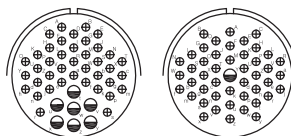

Insert Arrangement	36-7	36-8
Contact Size - No. of Contacts	#16-40, #12-7	#16-46, #12-1
Service Rating	A	A

48 CONTACTS

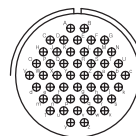

Insert Arrangement	36-10
Contact Size - No. of Contacts	#16-48
Service Rating	A

52 CONTACTS

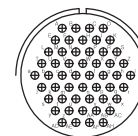

Insert Arrangement	36-52
Contact Size - No. of Contacts	#16-52
Service Rating	A

I/MS 3100A Wall Mounting Receptacle

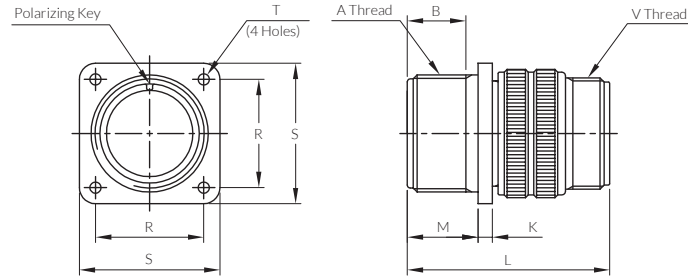

Unit : mm

Part No.	A Thread Class 2A	B min	K min / max	L Ref.	M +0.79 -0.00	R ±0.13	S ±0.79	T dia. +0.25 -0.13	V Thread Class 2A
I/MS 3100A 10SL	5/8-24 UNEF	9.53	1.57 / 3.96	38.89	14.27	18.26	25.40	3.05	5/8-24 UNEF
I/MS 3100A 12s	3/4-20 UNEF	9.53	1.57 / 3.96	42.88	14.27	20.62	27.79	3.05	5/8-24 UNEF
I/MS 3100A 12	3/4-20 UNEF	9.53	1.57 / 3.96	52.37	19.05	20.62	27.79	3.05	5/8-24 UNEF
I/MS 3100A 14s	7/8-20 UNEF	9.53	1.57 / 3.96	42.88	14.27	23.01	30.18	3.05	3/4-20 UNEF
I/MS 3100A 16s	1-20 UNEF	9.53	1.57 / 3.96	42.88	14.27	24.61	32.54	3.05	7/8-20 UNEF
I/MS 3100A 16	1-20 UNEF	15.88	1.57 / 3.96	52.37	19.05	24.61	32.54	3.05	7/8-20 UNEF
I/MS 3100A 18	1 1/8-18 UNEF	15.88	2.39 / 5.16	52.37	19.05	26.97	34.93	3.05	1-20 UNEF
I/MS 3100A 20	1 1/4-18 UNEF	15.88	2.39 / 5.16	55.58	19.05	29.36	38.10	3.05	1 3/16-18 UNEF
I/MS 3100A 22	1 3/8-18 UNEF	15.88	2.39 / 5.16	55.58	19.05	31.75	41.28	3.05	1 3/16-18 UNEF
I/MS 3100A 24	1 1/2-18 UNEF	15.88	2.39 / 5.16	58.72	20.62	34.93	44.45	3.73	1 7/16-18 UNEF
I/MS 3100A 28	1 3/4-18 UNS	15.88	2.39 / 5.16	58.72	20.62	39.67	50.80	3.73	1 7/16-18 UNEF
I/MS 3100A 32	2-18 UNS	15.88	3.18 / 9.12	61.93	22.23	44.45	57.15	4.39	1 3/4-18 UNS
I/MS 3100A 36	2 1/4-16 UN	15.88	3.18 / 9.12	61.93	22.23	49.23	63.50	4.39	2-18 UNS

I/MS 3100E or F Wall Mounting Receptacle

Integral Cable Clamp with Grommet

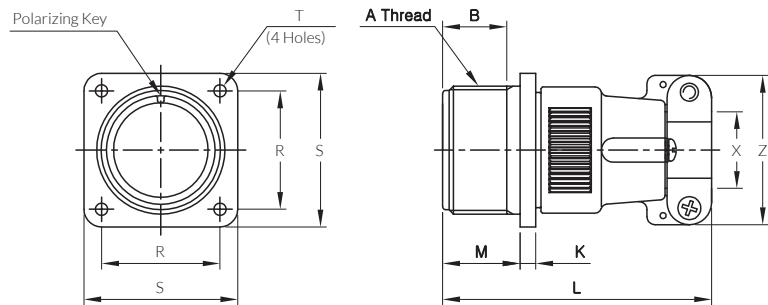

Unit : mm

Part No.	A Thread Class 2A	B min	K min / max	L Ref.	M +0.79 -0.00	R ±0.13	S ±0.79	T dia. +0.25 -0.13	X min. Cable range	Z ±0.79
I/MS 3100E/F 10SL	5/8-24 UNEF	9.53	1.57 / 3.96	57.15	14.27	18.26	25.40	3.05	7.14	22.23
I/MS 3100E/F 12s	3/4-20 UNEF	9.53	1.57 / 3.96	57.15	14.27	20.62	27.79	3.05	7.14	22.23
I/MS 3100E/F 12	3/4-20 UNEF	9.53	1.57 / 3.96	66.68	19.05	20.62	27.79	3.05	7.14	22.23
I/MS 3100E/F 14s	7/8-20 UNEF	9.53	1.57 / 3.96	57.15	14.27	23.01	30.18	3.05	10.31	26.97
I/MS 3100E/F 16s	1-20 UNEF	9.53	1.57 / 3.96	57.15	14.27	24.61	32.54	3.05	12.70	29.36
I/MS 3100E/F 16	1-20 UNEF	15.88	1.57 / 3.96	66.68	19.05	24.61	32.54	3.05	12.70	29.36
I/MS 3100E/F 18	1 1/8-18 UNEF	15.88	2.39 / 5.16	68.28	19.05	26.97	34.93	3.05	13.49	31.75
I/MS 3100E/F 20	1 1/4-18 UNEF	15.88	2.39 / 5.16	69.85	19.05	29.36	38.10	3.05	16.66	37.31
I/MS 3100E/F 22	1 3/8-18 UNEF	15.88	2.39 / 5.16	69.85	19.05	31.75	41.28	3.05	19.05	37.31
I/MS 3100E/F 24	1 1/2-18 UNEF	15.88	2.39 / 5.16	75.41	20.62	34.93	44.45	3.73	19.84	42.88
I/MS 3100E/F 28	1 3/4-18 UNS	15.88	2.39 / 5.16	76.99	20.62	39.67	50.80	3.73	23.42	42.88
I/MS 3100E/F 32	2-18 UNS	15.88	3.18 / 9.12	76.99	22.23	44.45	57.15	4.39	29.36	51.59
I/MS 3100E/F 36	2 1/4-16 UN	15.88	3.18 / 9.12	83.34	22.23	49.23	63.50	4.39	31.75	57.94

I/MS 3100R Wall Mounting Receptacle

Shorter & Lightweight Endbell with Grommet

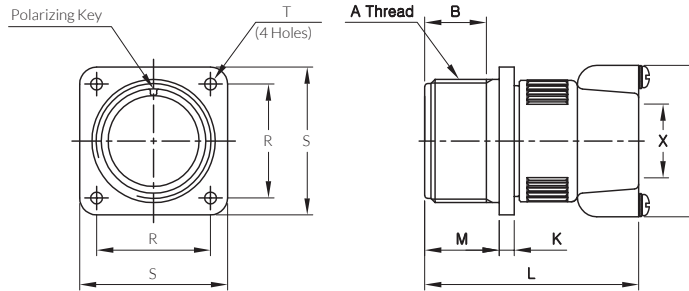

Unit : mm

Part No.	A Thread Class 2A	B min	K min / max	L Ref.	M +0.79 -0.00	R ±0.13	S ±0.79	T dia. +0.25 -0.13	X min. Cable range	Z ±0.79
I/MS 3100R 10SL	5/8-24 UNEF	9.53	1.57 / 3.96	46.69	14.27	18.26	25.40	3.05	7.14	23.83
I/MS 3100R 12s	3/4-20 UNEF	9.53	1.57 / 3.96	46.69	14.27	20.62	27.79	3.05	7.14	23.83
I/MS 3100R 12	3/4-20 UNEF	9.53	1.57 / 3.96	55.40	19.05	20.62	27.79	3.05	7.14	23.83
I/MS 3100R 14s	7/8-20 UNEF	9.53	1.57 / 3.96	46.69	14.27	23.01	30.18	3.05	10.31	28.58
I/MS 3100R 16s	1-20 UNEF	9.53	1.57 / 3.96	46.69	14.27	24.61	32.54	3.05	12.70	30.96
I/MS 3100R 16	1-20 UNEF	15.88	1.57 / 3.96	55.40	19.05	24.61	32.54	3.05	12.70	30.96
I/MS 3100R 18	1 1/8-18 UNEF	15.88	2.39 / 5.16	57.94	19.05	26.97	34.93	3.05	13.49	35.71
I/MS 3100R 20	1 1/4-18 UNEF	15.88	2.39 / 5.16	57.94	19.05	29.36	38.10	3.05	16.66	38.10
I/MS 3100R 22	1 3/8-18 UNEF	15.88	2.39 / 5.16	57.94	19.05	31.75	41.28	3.05	19.05	39.67
I/MS 3100R 24	1 1/2-18 UNEF	15.88	2.39 / 5.16	57.94	20.62	34.93	44.45	3.73	19.84	46.84
I/MS 3100R 28	1 3/4-18 UNS	15.88	2.39 / 5.16	57.94	20.62	39.67	50.80	3.73	23.42	46.84
I/MS 3100R 32	2-18 UNS	15.88	3.18 / 9.12	58.98	22.23	44.45	57.15	4.39	29.36	53.98
I/MS 3100R 36	2 1/4-16 UN	15.88	3.18 / 9.12	58.98	22.23	49.23	63.50	4.39	31.75	58.72

I/MS 3101A Cable Connecting Plug

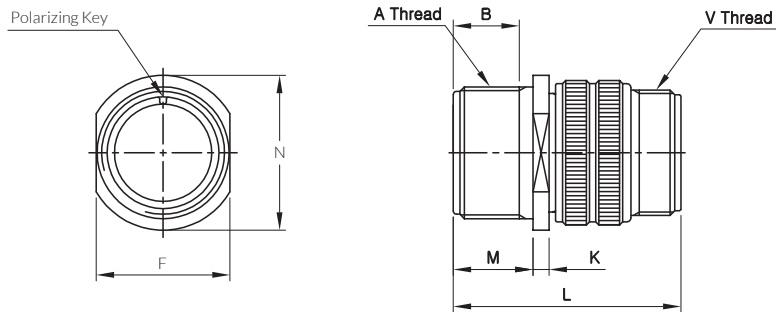

Unit : mm

Part No.	A Thread Class 2A	B min	F Ref	K min / max	L Ref.	M +0.79 -0.00	N dia. max	V Thread Class 2A
I/MS 3101A 10SL	5/8-24 UNEF	9.53	16.45	1.57 / 3.96	38.89	14.27	24.61	5/8-24 UNEF
I/MS 3101A 12s	3/4-20 UNEF	9.53	20.02	1.57 / 3.96	42.88	14.27	26.97	5/8-24 UNEF
I/MS 3101A 12	3/4-20 UNEF	9.53	20.02	1.57 / 3.96	52.37	19.05	26.97	5/8-24 UNEF
I/MS 3101A 14s	7/8-20 UNEF	9.53	22.61	1.57 / 3.96	42.88	14.27	29.36	3/4-20 UNEF
I/MS 3101A 16s	1-20 UNEF	9.53	25.78	1.57 / 3.96	42.88	14.27	31.75	7/8-20 UNEF
I/MS 3101A 16	1-20 UNEF	15.88	25.78	1.57 / 3.96	52.37	19.05	31.75	7/8-20 UNEF
I/MS 3101A 18	1 1/8-18 UNEF	15.88	28.96	2.39 / 5.16	52.37	19.05	34.14	1-20 UNEF
I/MS 3101A 20	1 1/4-18 UNEF	15.88	32.13	2.39 / 5.16	55.58	19.05	37.31	1 3/16-18 UNEF
I/MS 3101A 22	1 3/8-18 UNEF	15.88	35.31	2.39 / 5.16	55.58	19.05	40.49	1 3/16-18 UNEF
I/MS 3101A 24	1 1/2-18 UNEF	15.88	38.48	2.39 / 5.16	58.72	20.62	43.66	1 7/16-18 UNEF
I/MS 3101A 28	1 3/4-18 UNS	15.88	44.83	2.39 / 5.16	58.72	20.62	50.01	1 7/16-18 UNEF
I/MS 3101A 32	2-18 UNS	15.88	51.18	3.18 / 9.12	61.93	22.23	56.36	1 3/4-18 UNS
I/MS 3101A 36	2 1/4-16 UN	15.88	57.66	3.18 / 9.12	61.93	22.23	62.71	2-18 UNS

I/MS 3101E or F Cable Connecting Plug

Integral Cable Clamp with Grommet

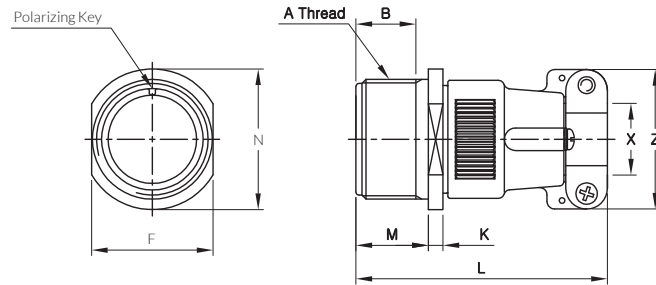

Unit : mm

Part No.	A Thread Class 2A	B min	F Ref	K min / max	L Ref.	M +0.79 -0.00	N dia. max	X min. Cable range	Z ±0.79
I/MS 3101E/F 10SL	5/8-24 UNEF	9.53	16.45	1.57 / 3.96	57.15	14.27	24.61	7.14	22.23
I/MS 3101E/F 12s	3/4-20 UNEF	9.53	20.02	1.57 / 3.96	57.15	14.27	26.97	7.14	22.23
I/MS 3101E/F 12	3/4-20 UNEF	9.53	20.02	1.57 / 3.96	66.68	19.05	26.97	7.14	22.23
I/MS 3101E/F 14s	7/8-20 UNEF	9.53	22.61	1.57 / 3.96	57.15	14.27	29.36	10.31	26.97
I/MS 3101E/F 16s	1-20 UNEF	9.53	25.78	1.57 / 3.96	57.15	14.27	31.75	12.70	29.36
I/MS 3101E/F 16	1-20 UNEF	15.88	25.78	1.57 / 3.96	66.68	19.05	31.75	12.70	29.36
I/MS 3101E/F 18	1 1/8-18 UNEF	15.88	28.96	2.39 / 5.16	68.28	19.05	34.14	13.49	31.75
I/MS 3101E/F 20	1 1/4-18 UNEF	15.88	32.13	2.39 / 5.16	69.85	19.05	37.31	16.66	37.31
I/MS 3101E/F 22	1 3/8-18 UNEF	15.88	35.31	2.39 / 5.16	69.85	19.05	40.49	19.05	37.31
I/MS 3101E/F 24	1 1/2-18 UNEF	15.88	38.48	2.39 / 5.16	75.41	20.62	43.66	19.84	42.88
I/MS 3101E/F 28	1 3/4-18 UNS	15.88	44.83	2.39 / 5.16	76.99	20.62	50.01	23.42	42.88
I/MS 3101E/F 32	2-18 UNS	15.88	51.18	3.18 / 9.12	76.99	22.23	56.36	29.36	51.59
I/MS3101E/F 36	2 1/4-16 UN	15.88	57.66	3.18 / 9.12	83.34	22.23	62.71	31.75	57.94

I/MS 3101R Cable Connecting Plug

Shorter & Lightweight Endbell with Grommet

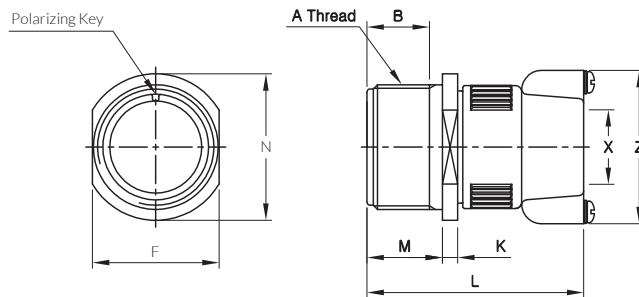

Unit : mm

Part No.	A Thread Class 2A	B min	F Ref	K min / max	L Ref.	M +0.79 -0.00	N dia. max	X min. Cable range	Z ±0.79
I/MS 3101R 10SL	5/8-24 UNEF	9.53	16.45	1.57 / 3.96	46.69	14.27	24.61	7.14	23.83
I/MS 3101R 12s	3/4-20 UNEF	9.53	20.02	1.57 / 3.96	46.69	14.27	26.97	7.14	23.83
I/MS 3101R 12	3/4-20 UNEF	9.53	20.02	1.57 / 3.96	55.40	19.05	26.97	7.14	23.83
I/MS 3101R 14s	7/8-20 UNEF	9.53	22.61	1.57 / 3.96	46.69	14.27	29.36	10.31	28.58
I/MS 3101R 16s	1-20 UNEF	9.53	25.78	1.57 / 3.96	46.69	14.27	31.75	12.70	30.96
I/MS 3101R 16	1-20 UNEF	15.88	25.78	1.57 / 3.96	55.40	19.05	31.75	12.70	30.96
I/MS 3101R 18	1 1/8-18 UNEF	15.88	28.96	2.39 / 5.16	57.94	19.05	34.14	13.49	35.71
I/MS 3101R 20	1 1/4-18 UNEF	15.88	32.13	2.39 / 5.16	57.94	19.05	37.31	16.66	38.10
I/MS 3101R 22	1 3/8-18 UNEF	15.88	35.31	2.39 / 5.16	57.94	19.05	40.49	19.05	39.67
I/MS 3101R 24	1 1/2-18 UNEF	15.88	38.48	2.39 / 5.16	57.94	20.62	43.66	19.84	46.84
I/MS 3101R 28	1 3/4-18 UNS	15.88	44.83	2.39 / 5.16	57.94	20.62	50.01	23.42	46.84
I/MS 3101R 32	2-18 UNS	15.88	51.18	3.18 / 9.12	58.98	22.23	56.36	29.36	53.98
I/MS 3101R 36	2 1/4-16 UN	15.88	57.66	3.18 / 9.12	58.98	22.23	62.71	31.75	58.72

I/MS 3102A or E Box Mounting Receptacle

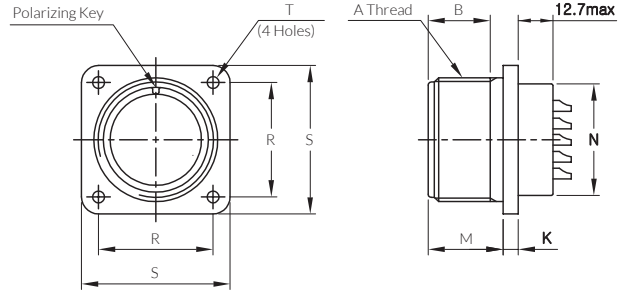

Unit : mm

Part No.	A Thread Class 2B	B min	K min / max	M +0.79 -0.00	N +0.00 -4.78	R ±0.13	S ±0.79	T dia. +0.25 -0.13
I/MS 3102A/E 10SL	5/8-24 UNEF	9.53	1.57 / 3.96	14.27	19.86	18.26	25.40	3.05
I/MS 3102A/E 12s	3/4-20 UNEF	9.53	1.57 / 3.96	14.27	19.86	20.62	27.79	3.05
I/MS 3102A/E 12	3/4-20 UNEF	9.53	1.57 / 3.96	19.05	19.86	20.62	27.79	3.05
I/MS 3102A/E 14s	7/8-20 UNEF	9.53	1.57 / 3.96	14.27	23.01	23.01	30.18	3.05
I/MS 3102A/E 16s	1-20 UNEF	9.53	1.57 / 3.96	14.27	26.21	24.61	32.54	3.05
I/MS 3102A/E 16	1-20 UNEF	15.88	1.57 / 3.96	19.05	26.21	24.61	32.54	3.05
I/MS 3102A/E 18	1 1/8-18 UNEF	15.88	2.39 / 5.16	19.05	29.36	26.97	34.93	3.05
I/MS 3102A/E 20	1 1/4-18 UNEF	15.88	2.39 / 5.16	19.05	32.56	29.36	38.10	3.05
I/MS 3102A/E 22	1 3/8-18 UNEF	15.88	2.39 / 5.16	19.05	35.71	31.75	41.28	3.05
I/MS 3102A/E 24	1 1/2-18 UNEF	15.88	2.39 / 5.16	20.62	38.91	34.93	44.45	3.73
I/MS 3102A/E 28	1 3/4-18 UNS	15.88	2.39 / 5.16	20.62	45.26	39.67	50.80	3.73
I/MS 3102A/E 32	2-18 UNS	15.88	3.18 / 9.12	22.23	51.61	44.45	57.15	4.39
I/MS 3102A/E 36	2 1/4-16 UN	15.88	3.18 / 9.12	22.23	57.96	49.23	63.50	4.39

I/MS 3106A Straight Plug

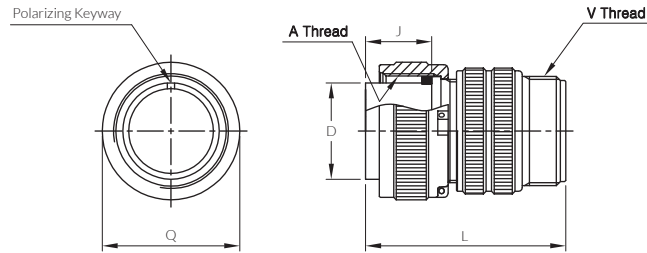

Unit : mm

Part No.	A Thread Class 2B	D +0.00 -0.38	J ±0.13	L Ref.	Q Ref.	V Thread Class 2A
I/MS 3106A 10SL	5/8-24 UNEF	11.33	13.49	38.89	24.61	5/8-24 UNEF
I/MS 3106A 12s	3/4-20 UNEF	14.10	13.49	42.88	26.97	5/8-24 UNEF
I/MS 3106A 12	3/4-20 UNEF	14.10	18.26	52.37	26.97	5/8-24 UNEF
I/MS 3106A 14s	7/8-20 UNEF	17.15	13.49	42.88	29.36	3/4-20 UNEF
I/MS 3106A 16s	1-20 UNEF	20.45	13.49	42.88	31.75	7/8-20 UNEF
I/MS 3106A 16	1-20 UNEF	20.45	18.26	52.37	31.75	7/8-20 UNEF
I/MS 3106A 18	1 1/8-18 UNEF	23.62	18.26	52.37	34.14	1-20 UNEF
I/MS 3106A 20	1 1/4-18 UNEF	26.67	18.26	55.58	37.31	1 3/16-18 UNEF
I/MS 3106A 22	1 3/8-18 UNEF	29.85	18.26	55.58	40.49	1 3/16-18 UNEF
I/MS 3106A 24	1 1/2-18 UNEF	33.02	18.26	58.92	43.66	1 7/16-18 UNEF
I/MS 3106A 28	1 3/4-18 UNS	38.61	18.26	58.92	50.01	1 7/16-18 UNEF
I/MS 3106A 32	2-18 UNS	44.96	18.26	61.93	56.36	1 3/4-18 UNS
I/MS 3106A 36	2 1/4-16 UN	50.29	18.26	61.93	62.71	2-18 UNS

I/MS 3106E or F Straight Plug

Integral Cable Clamp with Grommet

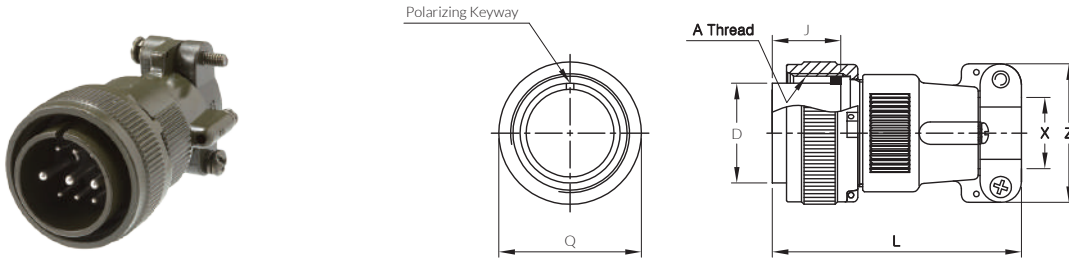

Unit : mm

Part No.	A Thread Class 2B	D +0.00 -0.38	J ±0.13	L Ref.	Q Ref.	X min. Cable range	Z ±0.79
I/MS 3106E/F 10SL	5/8-24 UNEF	11.33	13.49	57.15	24.61	7.14	22.23
I/MS 3106E/F 12s	3/4-20 UNEF	14.10	13.49	57.15	26.97	7.14	22.23
I/MS 3106E/F 12	3/4-20 UNEF	14.10	18.26	66.68	26.97	7.14	22.23
I/MS 3106E/F 14s	7/8-20 UNEF	17.15	13.49	57.15	29.36	10.31	26.97
I/MS 3106E/F 16s	1-20 UNEF	20.45	13.49	57.15	31.75	12.70	29.36
I/MS 3106E/F 16	1-20 UNEF	20.45	18.26	66.68	31.75	12.70	29.36
I/MS 3106E/F 18	1 1/8-18 UNEF	23.62	18.26	68.28	34.14	13.49	31.75
I/MS 3106E/F 20	1 1/4-18 UNEF	26.67	18.26	69.85	37.31	16.66	37.31
I/MS 3106E/F 22	1 3/8-18 UNEF	29.85	18.26	69.85	40.49	19.05	37.31
I/MS 3106E/F 24	1 1/2-18 UNEF	33.02	18.26	75.41	43.66	19.84	42.88
I/MS 3106E/F 28	1 3/4-18 UNS	38.61	18.26	76.99	50.01	23.42	42.88
I/MS 3106E/F 32	2-18 UNS	44.96	18.26	76.99	56.36	29.36	51.59
I/MS 3106E/F 36	2 1/4-16 UN	50.29	18.26	83.34	62.71	31.75	57.94

I/MS 3106R Straight Plug

Shorter & Lightweight Endbell with Grommet

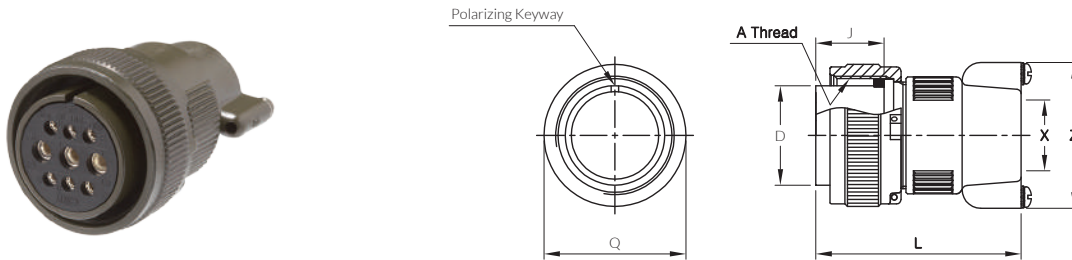

Unit : mm

Part No.	A Thread Class 2B	D +0.00 -0.38	J ±0.13	L Ref.	Q Ref.	X min. Cable range	Z ±0.79
I/MS 3106R 10SL	5/8-24 UNEF	11.33	13.49	46.69	24.61	7.14	23.83
I/MS 3106R 12s	3/4-20 UNEF	14.10	13.49	46.69	26.97	7.14	23.83
I/MS 3106R 12	3/4-20 UNEF	14.10	18.26	55.40	26.97	7.14	23.83
I/MS 3106R 14s	7/8-20 UNEF	17.15	13.49	46.69	29.36	10.31	28.58
I/MS 3106R 16s	1-20 UNEF	20.45	13.49	46.69	31.75	12.70	30.96
I/MS 3106R 16	1-20 UNEF	20.45	18.26	55.40	31.75	12.70	30.96
I/MS 3106R 18	1 1/8-18 UNEF	23.62	18.26	57.94	34.14	13.49	35.71
I/MS 3106R 20	1 1/4-18 UNEF	26.67	18.26	57.94	37.31	16.66	38.10
I/MS3106R 22	1 3/8-18 UNEF	29.85	18.26	57.94	40.49	19.05	39.67
I/MS3106R 24	1 1/2-18 UNEF	33.02	18.26	57.94	43.66	19.84	46.84
I/MS 3106R 28	1 3/4-18 UNS	38.61	18.26	57.94	50.01	23.42	46.84
I/MS 3106R 32	2-18 UNS	44.96	18.26	58.98	56.36	29.36	53.98
I/MS 3106R 36	2 1/4-16 UN	50.29	18.26	58.98	62.71	31.75	58.7

I/MS 3108A or E/R 90° Angle Plug

E/R with Grommet

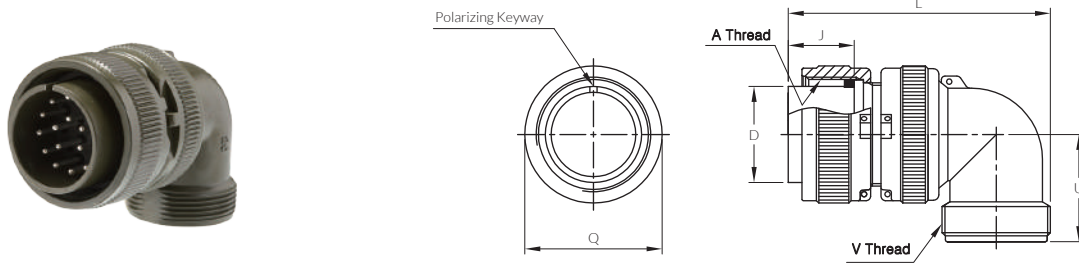

Unit : mm

Part No.	A Thread Class 2B	D +0.00 -0.38	J ±0.13	L Ref.	Q Ref.	U max.	V Thread Class 2A
I/MS 3108A, E/R 10SL	5/8-24 UNEF	11.33	13.49	46.02	24.61	25.40	5/8-24 UNEF
I/MS 3108A, E/R 12s	3/4-20 UNEF	14.10	13.49	50.80	26.97	26.97	5/8-24 UNEF
I/MS 3108A, E/R 12	3/4-20 UNEF	14.10	18.26	57.15	26.97	26.97	5/8-24 UNEF
I/MS 3108A, E/R 14s	7/8-20 UNEF	17.15	13.49	53.98	29.36	28.58	3/4-20 UNEF
I/MS 3108A, E/R 16s	1-20 UNEF	20.45	13.49	60.33	31.75	30.18	7/8-20 UNEF
I/MS 3108A, E/R 16	1-20 UNEF	20.45	18.26	65.07	31.75	30.18	7/8-20 UNEF
I/MS 3108A, E/R 18	1 1/8-18 UNEF	23.62	18.26	68.28	34.14	33.32	1-20 UNEF
I/MS 3108A, E/R 20	1 1/4-18 UNEF	26.67	18.26	76.99	37.31	34.93	1 3/16-18 UNEF
I/MS 3108A, E/R 22	1 3/8-18 UNEF	29.85	18.26	76.99	40.49	34.93	1 3/16-18 UNEF
I/MS 3108A, E/R 24	1 1/2-18 UNEF	33.02	18.26	86.51	43.66	39.67	1 7/16-18 UNEF
I/MS 3108A, E/R 28	1 3/4-18 UNS	38.61	18.26	86.51	50.01	39.67	1 7/16-18 UNEF
I/MS 3108A, E/R 32	2-18 UNS	44.96	18.26	95.25	56.36	47.63	1 3/4-18 UNS
I/MS 3108A, E/R 36	2 1/4-16 UN	50.29	18.26	100.03	62.71	52.37	2-18 UNS

I/MS 3108F 90° Angle Plug

Integral Cable Clamp with Grommet

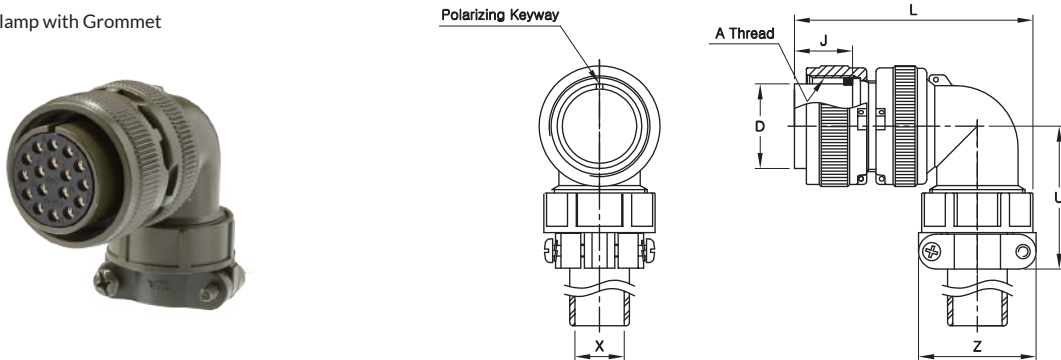

Unit : mm

Part No.	A Thread Class 2B	D +0.00 -0.38	J ±0.13	L Ref.	Q Ref.	U max.	X ±0.41	Z ±0.79
I/MS 3108F 10SL	5/8-24 UNEF	11.33	13.49	55.58	24.61	38.10	5.59	22.23
I/MS 3108F 12s	3/4-20 UNEF	14.10	13.49	55.58	26.97	38.10	5.59	22.23
I/MS 3108F 12	3/4-20 UNEF	14.10	18.26	64.29	26.97	38.10	5.59	22.23
I/MS 3108F 14s	7/8-20 UNEF	17.15	13.49	58.72	29.36	40.49	7.92	26.97
I/MS 3108F 16s	1-20 UNEF	20.45	13.49	61.11	31.75	42.88	11.10	29.36
I/MS 3108F 16	1-20 UNEF	20.45	18.26	70.64	31.75	42.88	11.10	29.36
I/MS 3108F 18	1 1/8-18 UNEF	23.62	18.26	72.24	34.14	45.24	14.27	31.75
I/MS 3108F 20	1 1/4-18 UNEF	26.67	18.26	82.55	37.31	50.01	15.88	37.31
I/MS 3108F 22	1 3/8-18 UNEF	29.85	18.26	82.55	40.49	50.80	15.88	37.31
I/MS 3108F 24	1 1/2-18 UNEF	33.02	18.26	94.46	43.66	53.98	19.05	42.88
I/MS 3108F 28	1 3/4-18 UNS	38.61	18.26	94.46	50.01	55.58	19.05	42.88
I/MS 3108F 32	2-18 UNS	44.96	18.26	106.38	56.36	65.89	23.80	51.59
I/MS 3108F 36	2 1/4-16 UN	50.29	18.26	109.14	62.71	69.06	31.75	57.94

I/MS 3057- ■ ■ A Cable Clamp with Rubber Bushing

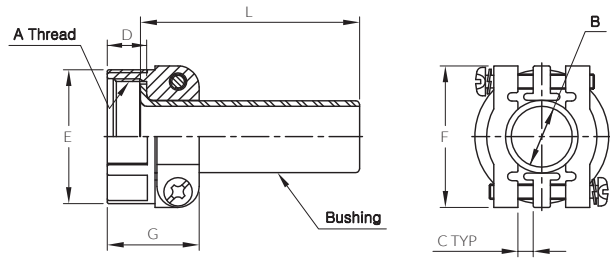

Unit : mm

Part No.	Connector Shell Size	A Thread Class 2B	B ±0.41	C TYP	D ±0.41	E ±0.79	F ±0.79	G ±0.79	L ±0.79	Bushing Ref.
I/MS 3057 - 4A	10SL, 12S & 12	5/8-24 UNEF	5.59	1.57	10.31	20.62	22.23	20.62	69.85	I/MS 3420 - 4A
I/MS 3057 - 6A	14S & 14	3/4-20 UNEF	7.92	1.98	10.31	24.61	26.97	22.23	66.68	I/MS 3420 - 6A
I/MS 3057 - 8A	16S & 16	7/8-20 UNEF	11.10	2.77	10.31	27.79	29.36	23.83	63.50	I/MS 3420 - 8A
I/MS 3057 - 10A	18	1-20 UNEF	14.27	3.18	10.31	30.18	31.75	23.83	60.33	I/MS 3420 - 10A
I/MS 3057 - 12A	20, 22	1 3/16-18UNEF	15.88	3.9	10.31	34.93	37.31	23.83	57.15	I/MS 3420 - 12A
I/MS 3057 - 16A	24, 28	1 7/16-18UNEF	19.05	4.78	10.31	42.06	42.88	26.19	53.98	I/MS 3420 - 16A
I/MS 3057 - 20A	32	1 3/4-18UNS	23.80	6.35	11.91	51.59	51.59	27.79	50.80	I/MS 3420 - 20A
I/MS 3057 - 24A	36	2-18UNS	31.75	7.54	13.49	56.36	57.94	29.36	47.63	I/MS 3420 - 24A

I/MS 3420 Rubber Bushing for Cable Clamps

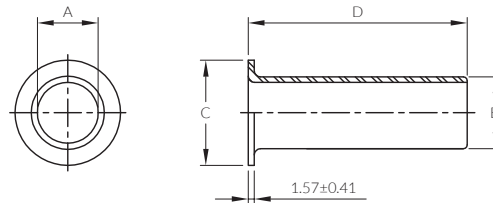

Unit : mm

Part No.	Connector Shell Size	A ±0.41	B ±0.41	G ±0.41	D ±0.79	Cable Clamp Ref.
I/MS 3420 - 4	10SL, 12S & 12	5.59	7.67	12.83	69.85	I/MS 3057 - 4A
I/MS 3420 - 6	14S & 14	7.92	10.85	15.72	66.68	I/MS 3057 - 6A
I/MS 3420 - 8	16S & 16	11.10	14.02	18.90	63.50	I/MS 3057 - 8A
I/MS 3420 - 10	18	14.27	15.62	22.58	60.33	I/MS 3057 - 10A
I/MS 3420 - 12	20, 22	15.88	18.80	27.53	57.15	I/MS 3057 - 12A
I/MS 3420 - 16	24, 28	19.05	23.55	33.38	53.98	I/MS 3057 - 16A
I/MS 3420 - 20	32	23.80	31.50	40.59	50.80	I/MS 3057 - 20A
I/MS 3420 - 24	36	31.75	34.67	46.91	47.63	I/MS 3057 - 24A

I/MS 25043 Protective Cover for Receptacle

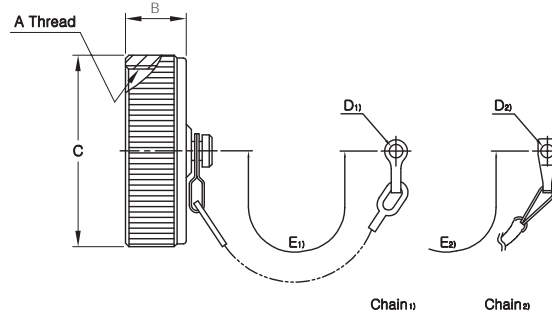

Unit : mm

Part No.	Connector Shell Size	A Thread Class 2B	B max.	C max.	D ₁ +0.25 -0.13	D ₂ +0.25 -0.13	E ₁ ±10.0	E ₂ ±ONE LINK
I/MS 25043 -10D	10SL	5/8-24 UNEF	11.91	20.70	3.80	4.80	125.0	101.6
I/MS 25043 -12D	12S & 12	3/4-20 UNEF	11.91	25.40	3.80	4.80	125.0	114.3
I/MS 25043 -14D	14S & 14	7/8-20 UNEF	11.91	28.58	3.80	4.80	125.0	114.3
I/MS 25043 -16D	16S & 16	1-20 UNEF	11.91	30.18	3.80	4.80	125.0	114.3
I/MS 25043 -18D	18	1 1/8-18 UNEF	11.91	34.14	3.80	4.80	125.0	114.3
I/MS 25043 -20D	20	1 1/4-18 UNEF	11.91	37.31	3.80	4.80	173.0	127.0
I/MS 25043 -22D	22	1 3/8-18 UNEF	11.91	40.49	3.80	4.80	173.0	139.7
I/MS 25043 -24D	24	1 1/2-18 UNEF	11.91	43.66	3.80	4.80	173.0	196.9
I/MS 25043 -28D	28	1 3/4-18 UNS	13.49	50.01	3.80	4.80	173.0	196.9
I/MS 25043 -32D	32	2-18 UNS	13.49	56.36	3.80	4.80	173.0	196.9
I/MS 25043 -36D	36	2 1/4-16 UN	13.49	62.71	3.80	4.80	173.0	196.9

NOTE : Chain(1) - INC standard (material - copper alloy)
Chain(2) - Available option (material - stainless steel)

I/MS 25042 Protective Cover for Plug

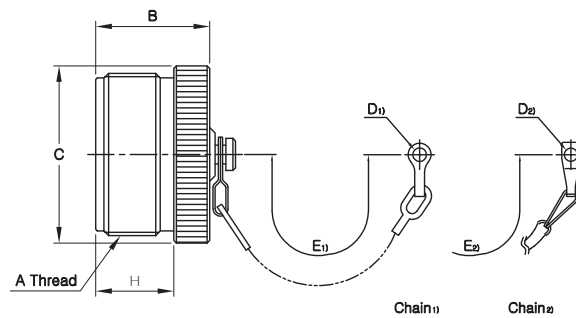

Unit : mm

Part No.	Connector Shell Size	A Thread Class 2A	B max.	C max.	D ₁ +0.25 -0.13	D ₂ +0.25 -0.13	E ₁ ±10.0	E ₂ ±ONE LINK	H min.
I/MS 25042 -10D	10SL	5/8-24 UNEF	16.66	17.45	3.80	4.80	125.0	101.6	9.65
I/MS 25042 -12D	12S & 12	3/4-20 UNEF	21.44	20.62	3.80	4.80	125.0	114.3	16.00
I/MS 25042 -14D	14S & 14	7/8-20 UNEF	21.44	23.80	3.80	4.80	125.0	114.3	16.00
I/MS 25042 -16D	16S & 16	1-20 UNEF	21.44	26.97	3.80	4.80	125.0	114.3	16.00
I/MS 25042 -18D	18	1 1/8-18 UNEF	21.44	30.15	3.80	4.80	125.0	114.3	16.00
I/MS 25042 -20D	20	1 1/4-18 UNEF	21.44	33.32	3.80	4.80	173.0	127.0	16.00
I/MS 25042 -22D	22	1 3/8-18 UNEF	21.44	36.50	3.80	4.80	173.0	139.7	16.00
I/MS 25042 -24D	24	1 1/2-18 UNEF	21.44	39.67	3.80	4.80	173.0	196.9	16.00
I/MS 25042 -28D	28	1 3/4-18 UNS	21.44	46.02	3.80	4.80	173.0	196.9	16.00
I/MS 25042 -32D	32	2-18 UNS	21.44	52.37	3.80	4.80	173.0	196.9	16.00
I/MS 25042 -36D	36	2 1/4-16 UN	21.44	58.72	3.80	4.80	173.0	196.9	16.00

NOTE : Chain(1) - INC standard (material - copper alloy)
Chain(2) - Available option (material - stainless steel)



MIL-DTL 5015 Series



MIL-DTL 26482 Series



VG95234 Series

POWER YOUR APPLICATIONS WITH
**CIRCULAR CONNECTORS
YOU CAN DEPEND ON**

Since 2002, INC has provided customers with circular connector solutions to power their specific applications. Over the years, we've expanded our product lines and services to meet market demands, while maintaining a commitment to top quality, competitive pricing and world class lead times. These efforts have made us a market leader in the circular connector industry and established a foundation to continue innovating for the future.



International
Network —
Connectors

www.inconnector.co.kr

This Connector Guide is intended to provide general information about various products. Information contained herein is for general reference only and subject to change without notice. Products may deviate from the listed description, specifications, technical data, dimensions and illustrations provided in this Connector Guide. Please contact INC to discuss your specific application to ensure that the desired products meet your specific requirements. No information or data contained in this Connector Guide shall be construed to create any liability on the part of INC.



International
Network —
Connectors

 21, CheongAn-ro, Bupyeong-gu, Incheon, Korea

 TEL +82-32-545-1411~3 FAX +82-32-545-1417

 www.inconnector.co.kr