

ROHS

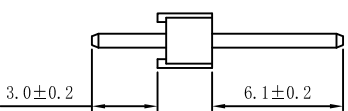
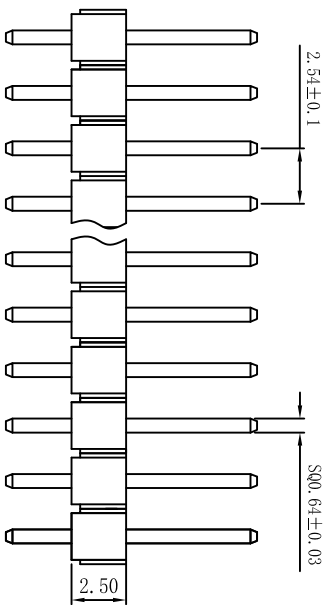
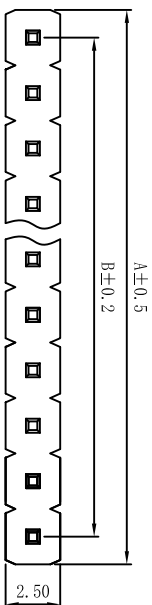

技术要求:  
Technical requirement  
一. 电气性能:  
electrical performance

- 1-1. 额定电流: 3A AC DC.  
rated current: 3A AC DC.
- 1-2. 接触电阻:  $\leq 20m\Omega$   
Contact resistance:  $\leq 20m\Omega$
- 1-3. 绝缘电阻:  $\geq 1000M\Omega$   
Insulation resistance:  $\geq 1000M\Omega$
- 1-4. 耐 压: 550V AC/Minute  
withstand voltage: 550V AC/Minute

二. 物理特性:  
Physical characteristics

- 2-1. 环境温度:  $-25^{\circ}C \sim 105^{\circ}C$   
environmental temperature:  $-25^{\circ}C \sim 105^{\circ}C$
- 2-2. 焊接温度:  $+260^{\circ}C$ , 10s max  
welding temperature:  $+260^{\circ}C$ , 10s max

三. 材质:  
Material

- 3-1. 塑胶: PA6T (Black) U194V-0  
plastic: PA6T (Black) U194V-0
- 3-2. 插针: 黄铜/镀金  
pin: Brass/Gold plated

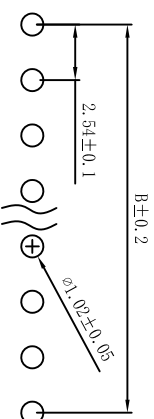

PCB LAYOUT

PIN	A	B
1x2A	5.08	2.54
1x3A	7.62	5.08
1x4A	10.16	7.62
1x5A	12.70	10.16
1x6A	15.24	12.70
1x7A	17.78	15.24
1x8A	20.32	17.78
1x9A	22.86	20.32
1x0A	25.40	22.86
1x1A	27.94	25.40
1x2A	30.48	27.94
1x3A	33.02	30.48
1x4A	35.56	33.02
1x5A	38.10	35.56
1x6A	40.64	38.10
1x7A	43.18	40.64
1x8A	45.72	43.18
1x9A	48.26	45.72
1x20A	50.80	48.26
1x21A	53.34	50.80
1x22A	55.88	53.34
1x23A	58.42	55.88
1x24A	60.96	58.42
1x25A	63.50	60.96
1x26A	66.04	63.50
1x27A	68.58	66.04
1x28A	71.12	68.58
1x29A	73.66	71.12
1x30A	76.20	73.66
1x31A	78.74	76.20
1x32A	81.28	78.74
1x33A	83.82	81.28
1x34A	86.36	83.82
1x35A	88.90	86.36
1x36A	91.44	88.90
1x37A	93.98	91.44
1x38A	96.52	93.98
1x39A	99.06	96.52
1x40A	101.60	99.06

ITEM	PART NAME	DESCRIPTION	QUANTITY	UNIT
3	包装	<input checked="" type="checkbox"/> 袋装 <input type="checkbox"/> 管装 <input type="checkbox"/> 卷装 <input type="checkbox"/> 盒装	1	PCS
2	塑胶	PH2. 54*2.50 1*40P PA6T料	1	PCS
1	方针	0.64mm L=11.6 黄铜镀金G/F	40	PCS

单位	mm	版本:	A0	产品名称	PH2. 54mm 排针 G/F 180度 1xNP
比例	1:1	审核:	1/1	产品料号	
SCALE	1:1	制图:	封文辉	客户料号	
核准:		日期:		客户料号	
审核:				Client No.	
制图:					
DATE					

东莞市常盈电子有限公司

图号	变更履历	设计日期
A0	CHANGE SHEET	DATE
	DESIGNER	