

4.00 mm CENTERS SINGLE LINE CONNECTORS

General

PCC1 series are traditional 4.00mm centers single line connectors featuring bellows contacts of 8 contact points in 2 steps which offer excellent electrical and mechanical

characteristics. 10, 14, 18 and 22 pin are line-uped with error-free polarizing key.

Material and Finish

Molding : UL94V-O, Glass-reinforced Polycarbonate, Blue
Contact : Phosphor Bronze, Whole gold Plating over nickel

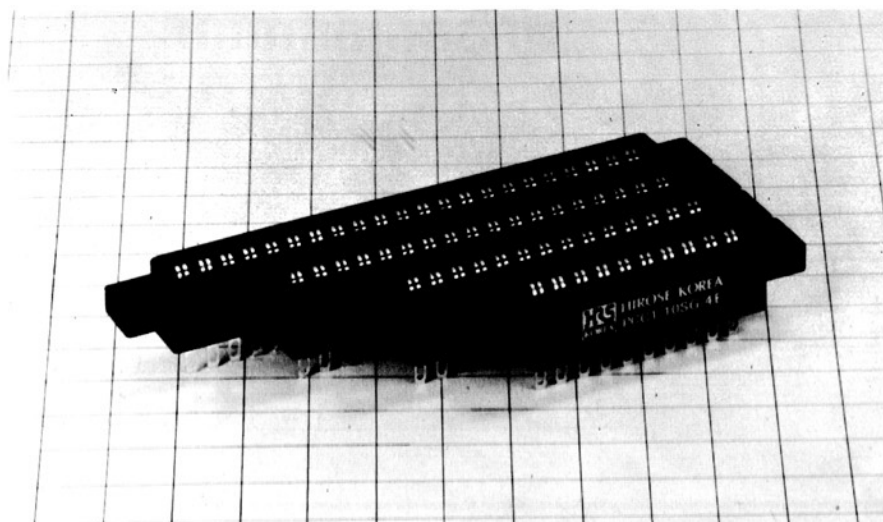

Electrical and Environmental Performance

Current Rating	: 5A
Voltage Rating	: AC600V, DC850V
Insulation Resistance	: 5000M Ω MIN at DC500V
Contact Resistance	: 10m Ω MAX at DC1A
Voltage Withstanding	: AC1800V MIN for a minute
Insertion and	
Extraction Force	: 57grs to 450grs/contact at 1.575 \pm 0.002mm steel gauge
Humidity	: MIL-STD-202, Insulation Resistance 1000M Ω MIN at 40 \pm 2°C, 90—95%, and 96 hours
Vibration	: MIL-STD-202, No visual damage nor looseness of parts at 10—55Hz with 1.5mm amplitude
Shock	: MIL-STD-202, No visual damage nor looseness of parts at 50G in 3 directions
Temperature Cycling	: MIL-STD-202, No visual damage at -55 to +85°C
Durability	: Contact Resistance 10m Ω MAX at DC1A after 500 times consecutive coupling operation
Salt Spray	: MIL-STD-202, No heavy corrosion at 5%, 35°C Salt Water spray for 48 hours

PCC1**Series****4.00 mm****CENTERS SINGLE LINE CONNECTORS**

mm

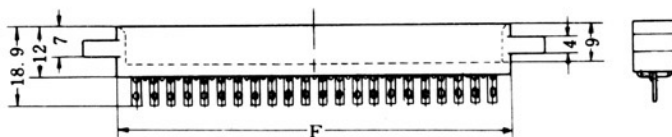
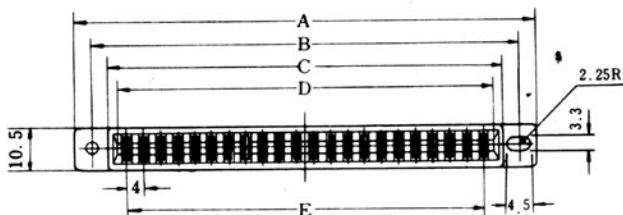
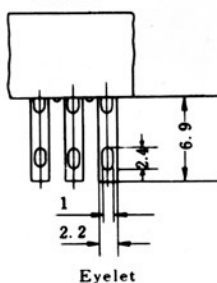
**Terminal**

No. of pin	Part No.	A	B	C	D	E	F
10	PCC1-10SG-4E	58	50	43	41	36	43
14	PCC1-14SG-4E	75	67	60	57	52	59
18	PCC1-18SG-4E	92	84	77	73	68	76
22	PCC1-22SG-4E	109	101	93	89	84	93

Mounting Cut Out

mm

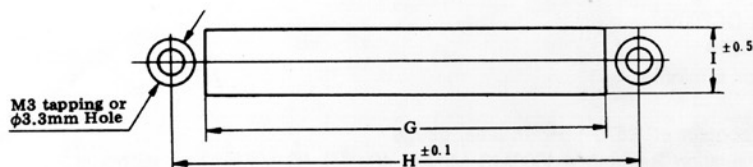

No. of pin	10	14	18	22
G	44	61	78	94
H	50	67	84	101
I	11.5			