

2.00mm Pitch Pin Header (PH03 Series)

REV	ECN NO.	APP.	DATE

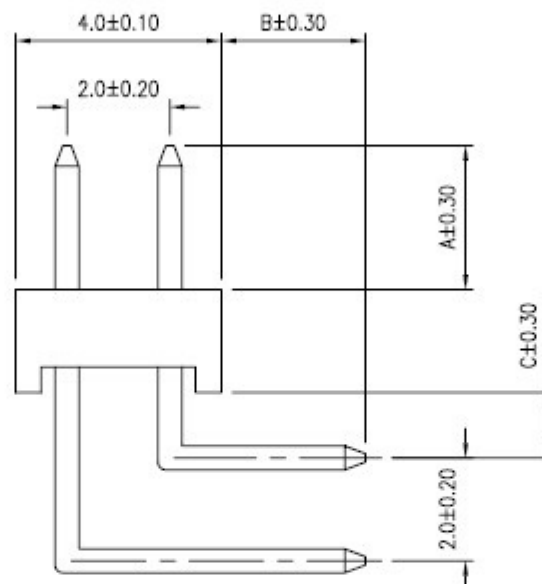
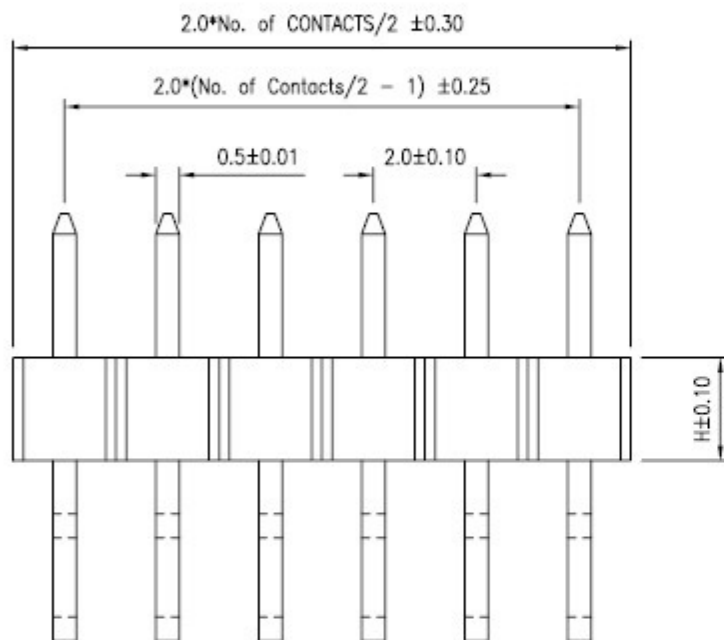

SPECIFICATION

- \* Current Rating: 2 A
- \* Withstanding Voltage: 600 VAC ( 1 min. )
- \* Insulation Resistance: 1000 Megohms MIN.
- \* Contact Resistance: 30 Milliohms MAX.
- \* Operating Temperature: -40°C to +85°C
- \* Retention Force: 600g MIN.

MATERIAL

- \* Contact: BRASS  
0.50mm square post
- \* Insulator: PBT & 30% G.F.
- \* Plating: All Gold

Number of Pin  
\*80Pin

Pin Chart

Pin	A	B	C
1	3.60	2.50	1.75
2			
3			
4			

Base Height

Base	H
1	2.0
2	1.5
3	
4	

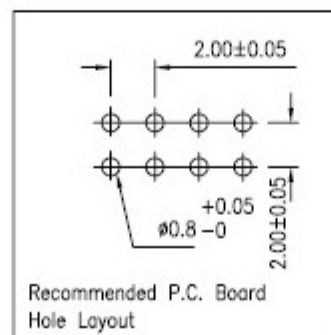

ELEPARTS Co.,Ltd

0.0±	SCALE:	TITLE:	PART NO:
0.00±	UNIT: MM	2.00X2.00MM (.079*.079") PIN	APP BY:
0.000±		HEADER Dual Row	CHK BY:
		MATL: PBT + 30% G.F.	DR BY:
		DWG. NO. PH03 Series	

ELEPARTS

E-BUSINESS